

Dimensioni Dimensions

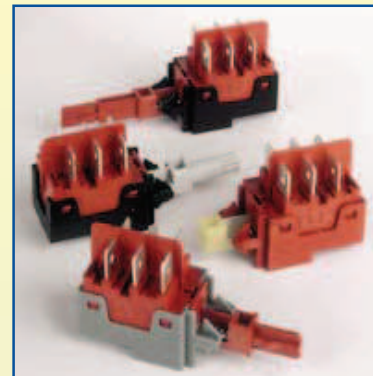

La serie SA

La serie SA rappresenta la giusta evoluzione degli interruttori modulari creati per essere applicati alle differenti produzioni di apparecchi elettrodomestici.

The SA series

SA series is the right development of modular switches manufactured just to be used on household appliances.

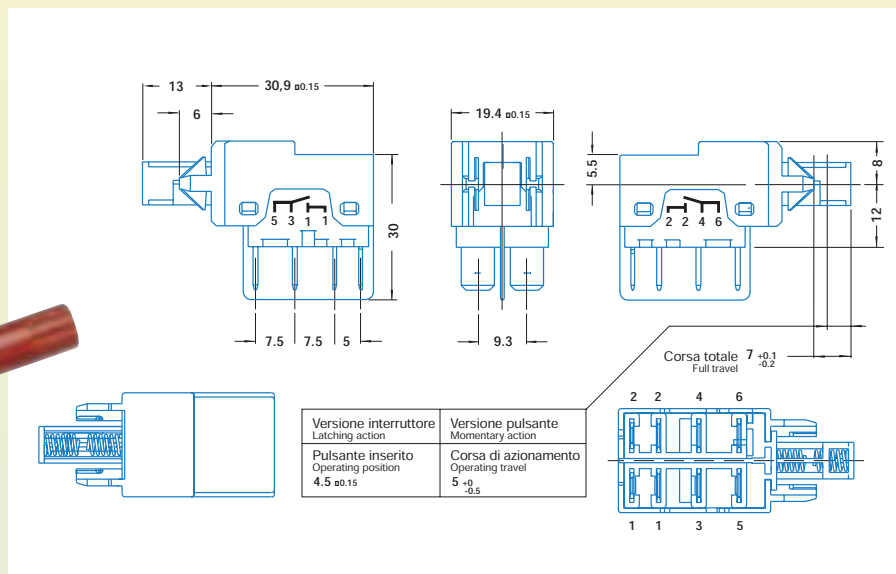
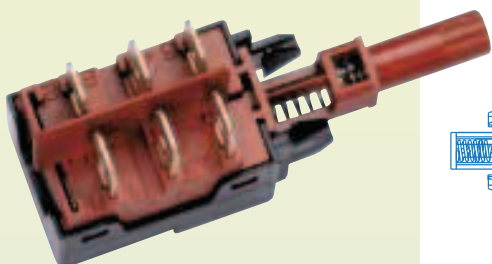

Foro di fissaggio

- Rapido fissaggio a scatto sul pannello mediante l'utilizzo di alette autobloccanti ricavate direttamente sulla parte superiore dell'interruttore.
- Possibilità di pre-carica del pulsante sino a 1 mm senza pregiudicare la funzionalità elettrica dell'interruttore.
- SA può essere applicato all'apparecchio utilizzatore direttamente su telaio o mediante una squadretta perchè dotato di un sistema di fissaggio rapido a scatto.

Panel cut-out

- Snap-in fixing on panel by means of self-locking wings (on upper part of switch).
- Possibility of shaft pre-loading up to 1 mm max without altering the electric operation of switch.
- SA can be mounted individually directly on the unit to which they are applied. Alternatively, one or more switches can be pre-mounted on a bracket. This is possible thanks to our specialised push-fit system. Switch can be manufactured either in the momentary version or in the maintained one.

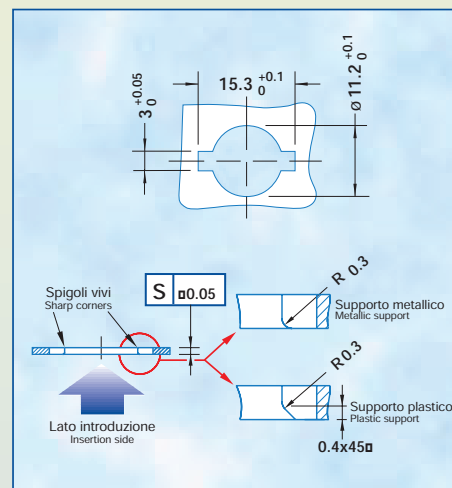

S	Sp. th. 1
	Sp. th. 1.2

Aste di comando

Shaft shapes

1

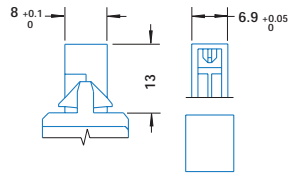
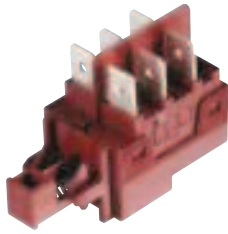

Pulsante base
Basic shaft

2

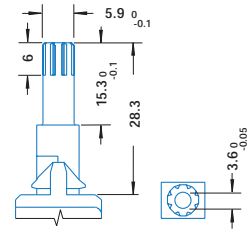
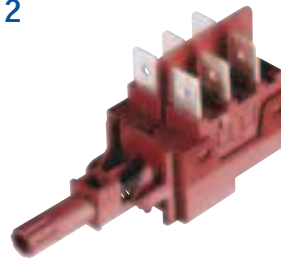

Pulsante tondo standard
Standard round shaft

3

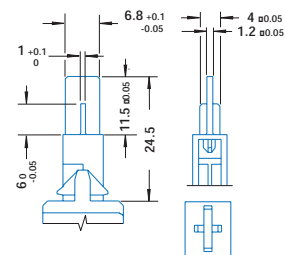
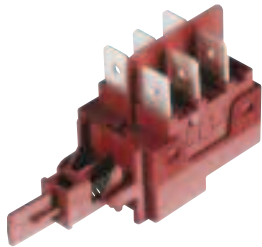

Pulsante croce h 24.5 mm
Low "cross" h 24.5 mm

4

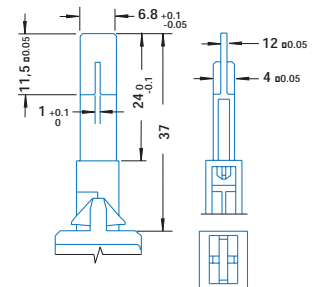
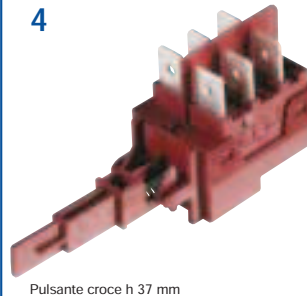

Pulsante croce h 37 mm
"Cross" shaft h 37 mm

5

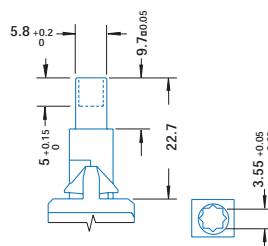
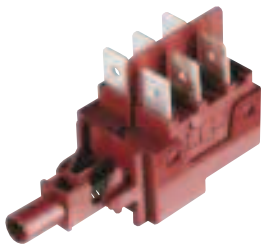

Pulsante tipo Domino
Domino shaft

6

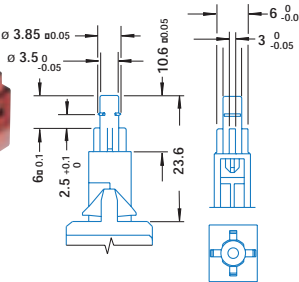
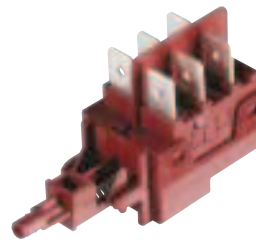

Pulsante aggancio tondo a scatto
Round push-fit fixing shaft

7

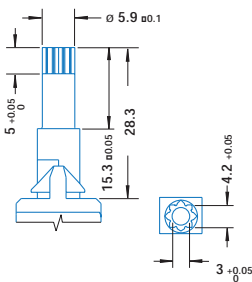
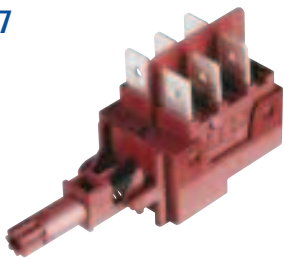

Pulsante a stella h 5 mm
Star shaped shaft h 5 mm

8

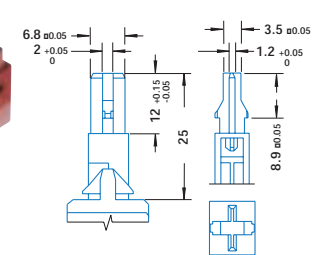
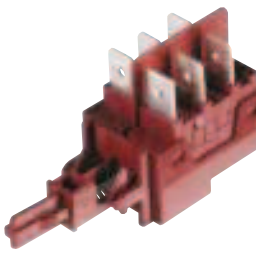

Pulsante croce a scatto
Snap "Cross" shaft

9

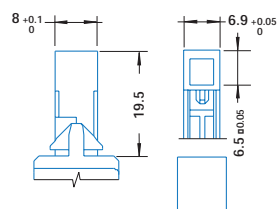
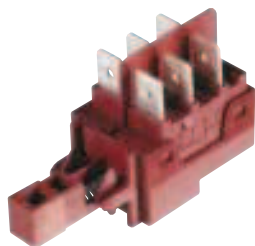

Pulsante base h 19.5 mm
Basic shaft h 19.5 mm

10

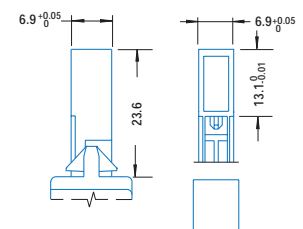
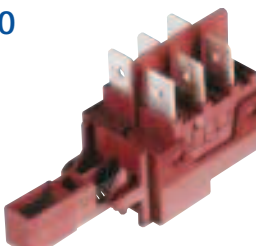

Pulsante base h 23.6 mm
Basic shaft h 23.6 mm

11

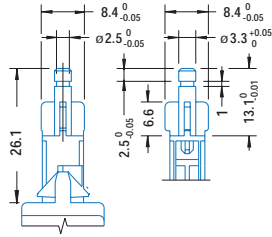
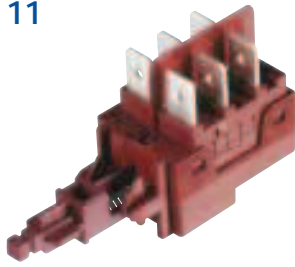

Quadro a scatto
Square snap shaft

12

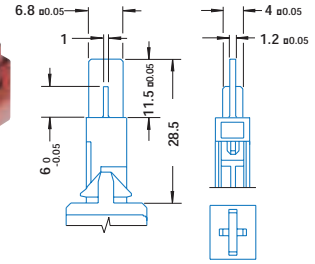
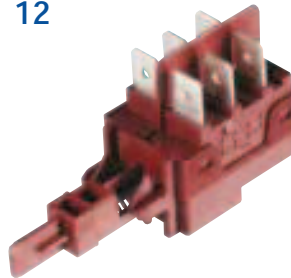

Pulsante a croce h 28.5 mm
"Cross" shaft h 28.5 mm

13

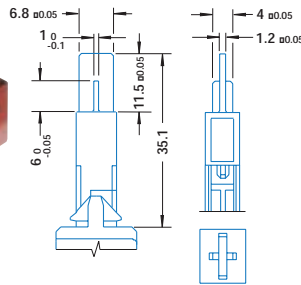
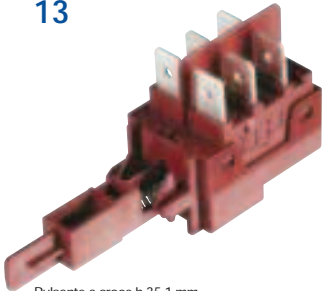

Pulsante a croce h 35.1 mm
"Cross" shaft h 35.1 mm

Schemi elettrici Electric diagrams

1	NA	2	NC	3	DEV	4	NA - Ponte	5	DEV - Ponte
6	NA	7	NC	8	DEV	9	NA - Ponte	10	DEV - Ponte
11	NA - NA	12	NC - NC	13	DEV - DEV	14	NA - NA - Ponte	15	DEV - DEV - Ponte
16	NA - NC	17	NA - DEV	18	NC - DEV	19	NA - DEV - Ponte	20	NA - Ponte - NA
21	NC - DEV - Ponte	22	DEV - NA	23	NC + RES - NA	24	DEV + RES	25	NA-NC + RES
26	NC + RES	27	NC + RES	NA = NO NC = NC DEV = Changeover Ponte = Bridge RES = Resistor					

Uscite faston

Terminal outlets

1

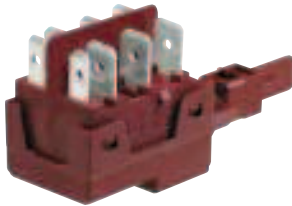

Terminale 6.3 x 0.8
Terminal 6.3 x 0.8

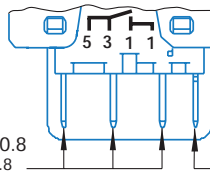

Terminale ponte 2.8 x 0.8
Terminal 2.8 x 0.8



2

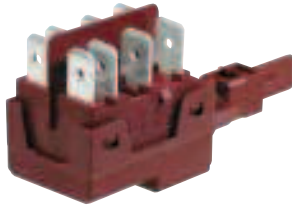

Terminale 6.3 x 0.8
Terminal 6.3 x 0.8

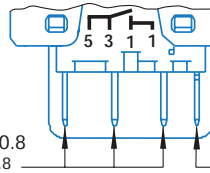

Terminale ponte 4.8 x 0.8
Bridge terminal 4.8 x 0.8



3

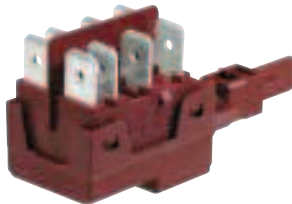

Terminale 6.3 x 0.8
Terminal 6.3 x 0.8

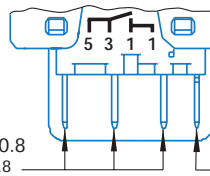

Terminale ponte 6.3 x 0.8
Bridge terminal 6.3 x 0.8



4



Con terminali piegati
a 15/30/45°
Terminals bent at 15/30/45°

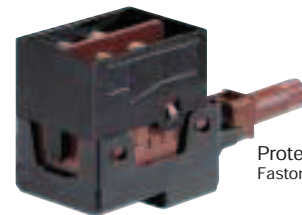
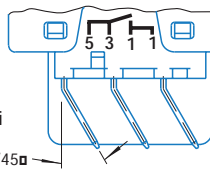

Protezione faston
Faston protection

Caratteristiche tecniche

Technical features

- Tutte le parti dell'interruttore sono costruite per sopportare un potere di interruzione di:
 - 16(6)A 250Vac 1E4 T85
 - 12(6)A 250Vac 5E4 T85
 - 16(2)A 250Vac 1E4 T150/55
 - 16A 1/2hp 125/250Vac UL-CSA
- Rigidità dielettrica: 3750Vac
- Distanza fra i contatti: >3 mm
- Protezione allo sporco: IP4X
- Protezione all'umidità: IP40
- PTI: 250Vac
- Glow Wire Test: 750°C no flame
- Classe di isolamento: II
- Numero minimo di interventi elettrici: 10.000
- Fissaggi: Snap in
- All parts of the switch are manufactured to withstand a load of:
 - 16(6)A 250Vac 1E4 T85
 - 12(6)A 250Vac 5E4 T85
 - 16(2)A 250Vac 1E4 T150/55
 - 16A 1/2hp 125/250Vac UL-CSA
- Dielectric strength: 3750Vac
- Distance between contacts: >3 mm
- Degree of protection against dust: IP4X
- Degree of protection against harmful ingress of water: IP40
- PTI: 250Vac
- Glow Wire Test: 750°C no flame
- Degree of protection against electric shock: Class II
- Min. number of electric actions: 10,000
- Fixing: Snap in